

Auto-Field Sampler (AFS) Pickup Truck Mounting Instructions

- **Warning:** The operator is responsible for securely installing the Auto-Field Sampler (AFS) to a pickup truck. AMS assumes no liability unless the installation's completed at an AMS facility.
- Mount the AFS using the *Pickup Truck Receiver Tube* and *Pickup Truck Mast Mount*.
- Insert the *Pickup Truck Receiver Tube* into the pickup truck's hitch receiver and secure it with a hitch pin.
 - **Note:** The *Pickup Truck Receiver Tube* may be positioned in two configurations, depending on the height of the pickup truck receiver to the ground. The bottom of the *Mast* should be 6 in. (15.24 cm) above ground level. Improper height will result in incomplete (less than 12 in. (30.48 cm)) sampling. See *Figures 6.1.2 A and B*.

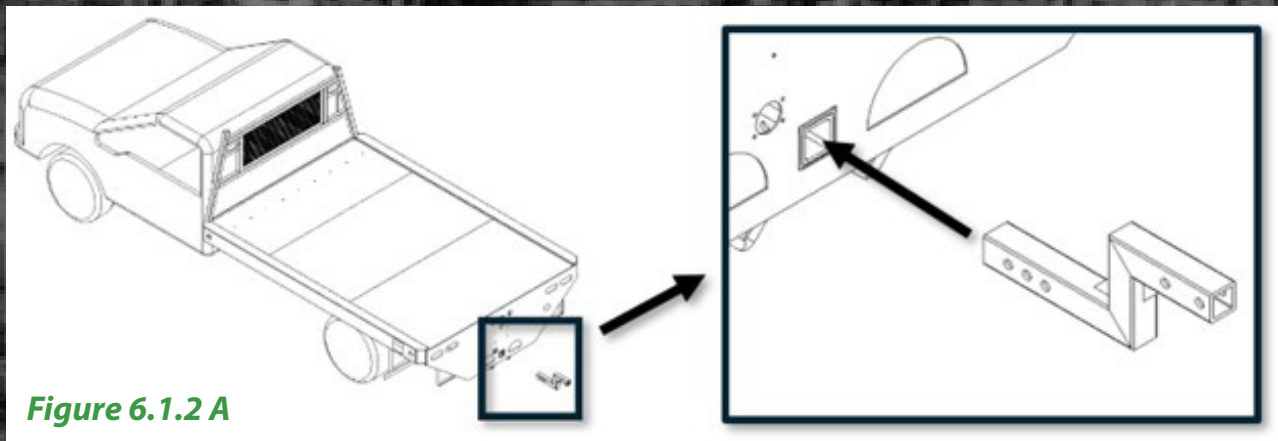

Figure 6.1.2 A

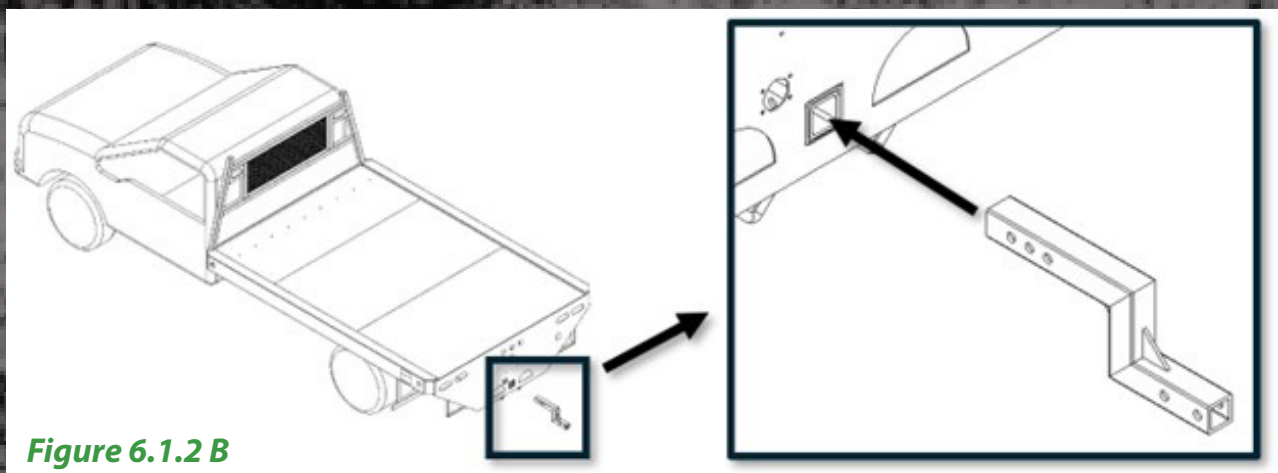

Figure 6.1.2 B



**Agricultural
Geotechnical
Environmental
Groundwater**

105 Harrison St.
American Falls, ID 83211

Toll Free: 800-635-7330
Office: 208-226-2017

ams@ams-samplers.com

facebook.com/amssampling

instagram.com/amsinc

linkedin.com/company/ams-inc

youtube.com/@amssamplersusa

ams-samplers.com

- Secure the *Pickup Truck Mast Mount* to the *Pickup Truck Receiver Tube* using two hitch pins and two 1/2 in. diameter bolts. See *Figures 6.1.2 C and D*.

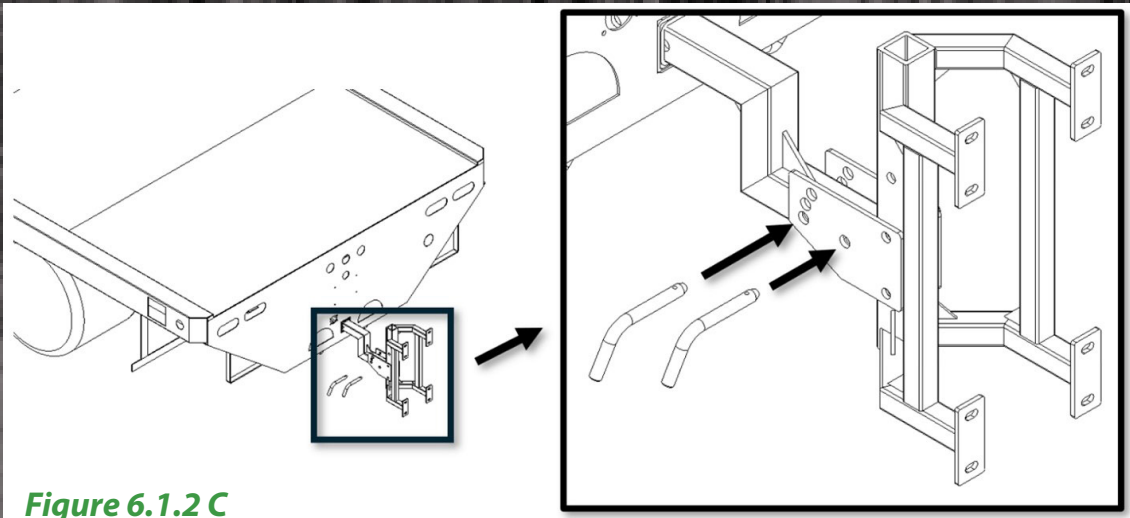

Figure 6.1.2 C

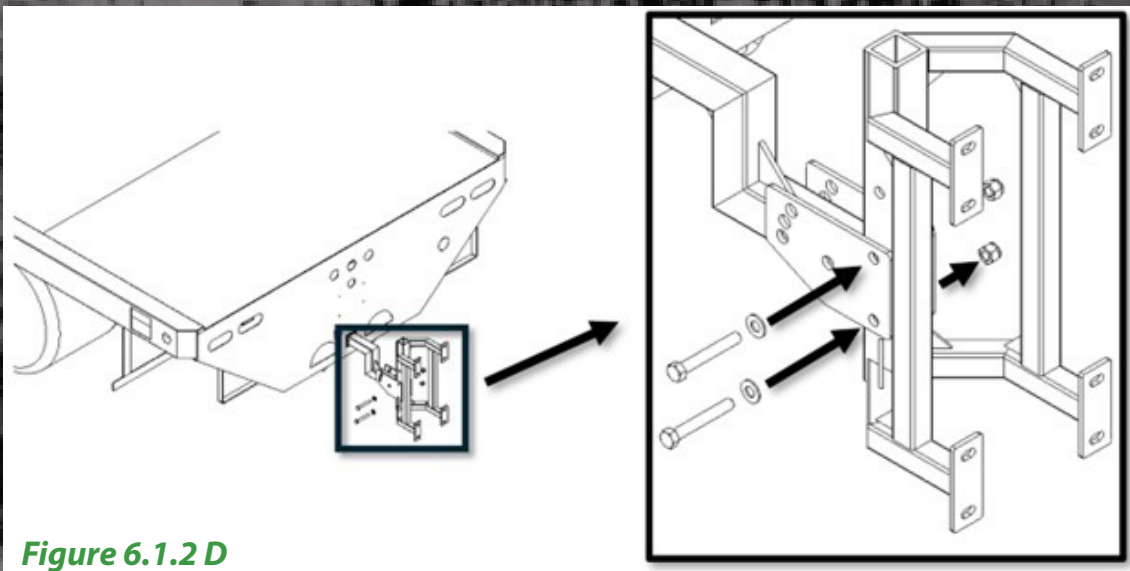

Figure 6.1.2 D

- Attach the *Mast* to the *Pickup Truck Mast Mount* using the flanged bolt holes. See *Figure 6.1.2 E*.

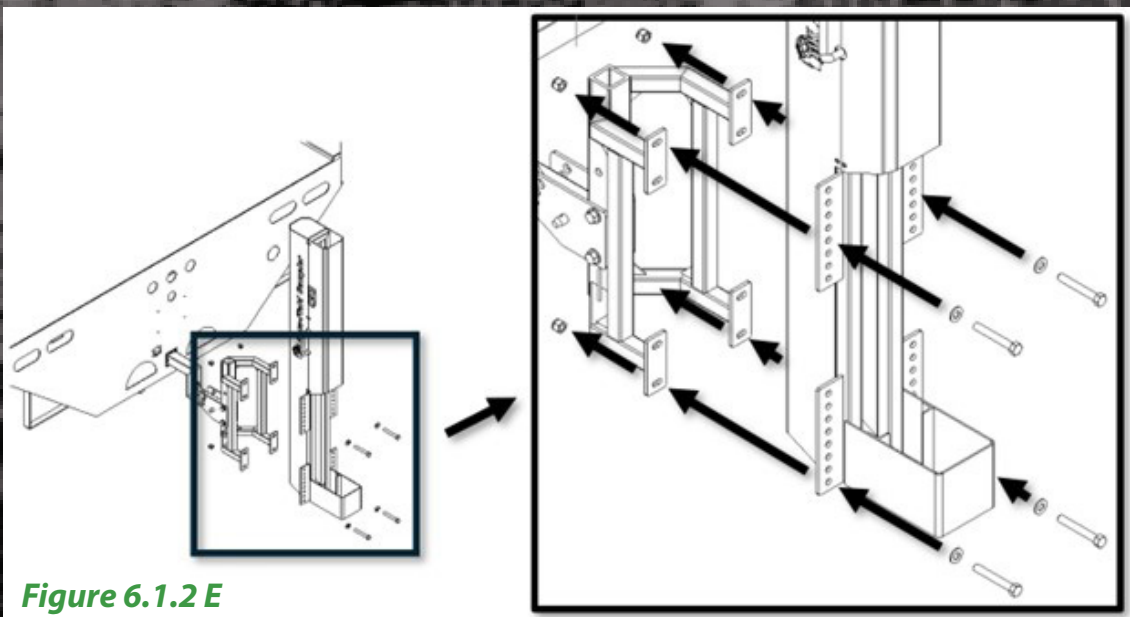
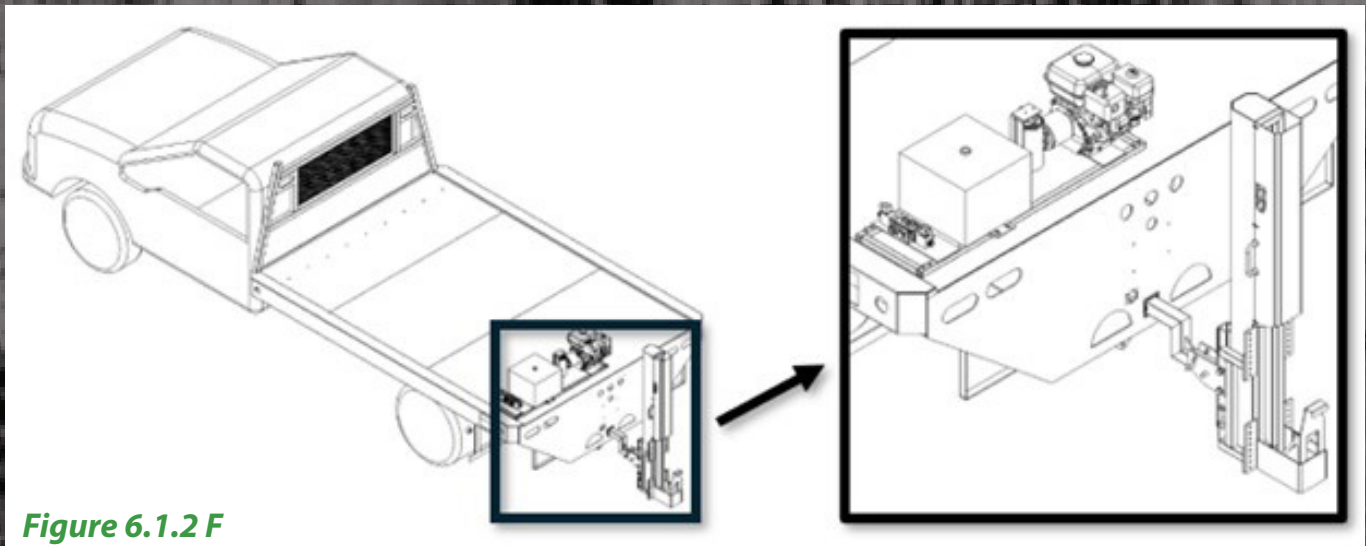
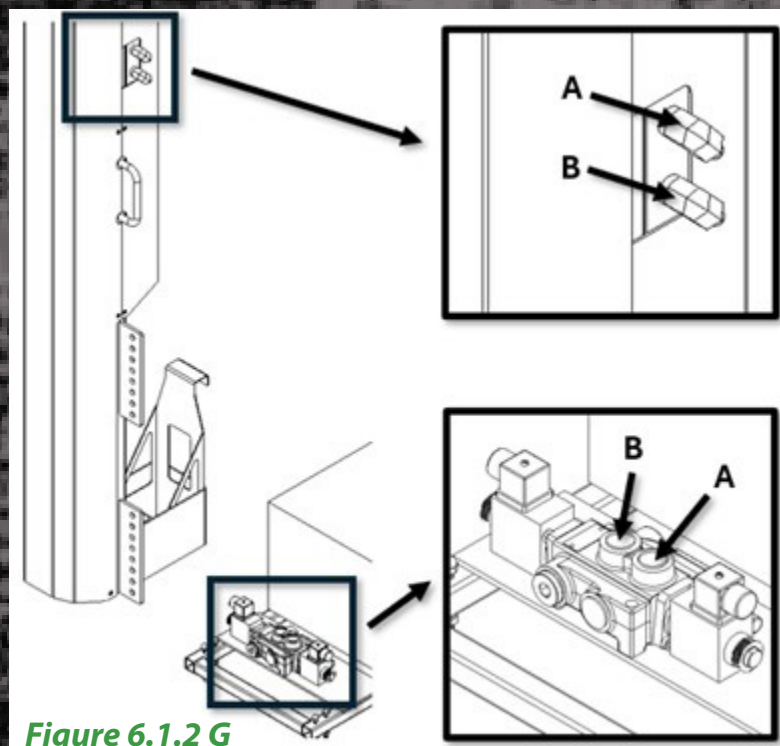

Figure 6.1.2 E

- Adjust the height using the flanged bolt holes. Maintain a 6 in. (15.24 cm) height from the ground to the bottom of the *Mast* to ensure a full 12 in. (30.48 cm) sample.
 - **Note:** The *Mast* mounting flanges include eight bolt holes; however, only four are necessary to properly secure the *Mast*. Use four 3/8 in. bolts—two in the top flange, two in the bottom flange.
- Mount the *Power Unit* securely in the bed or rear of the pickup truck. See *Figure 6.1.2 F*.
 - **Note:** Ensure that the *Mast* will not contact the *Power Unit* when pivoted into the transport position. See *Figure 6.1.2 H*.



- Connect the hydraulic hoses—A to A, B to B—as shown in *Figure 6.1.2 G*.



- Connect the **Power Unit** to a 12V power source using the included 10 ft. (3.05 m) bare-wire extension. Trim to length as needed. Battery terminals are provided; accessory connectors aren't included.
- Before transport, pivot the **Mast** to the transport position to prevent ground contact.
 - **Warning:** Failure to pivot the **Mast** before travel may result in damage to the AFS or pickup truck.
- To enter the transport position, remove the appropriate hitch pin, tilt the **Pickup Truck Mast Mount** backward toward the pickup truck bed, and reinstall the hitch pin before driving. See **Figure 6.1.2 H**.
 - **Warning:** Failure to reinstall the hitch pin before travel may result in damage to the AFS or pickup truck. See **Figure 6.1.2 I**.

